

# Maintenance Manual

**Instandhaltungsanleitung  
Manuel d'entretien  
Istruzioni per la manutenzione**

**KNOW  
HOW**  
INSTALLED

Table of Contents

**Information..... 2**

**Safety..... 3**

Target group..... 3

Safety notes ..... 3

**Product description..... 4**

Structure..... 4

Function ..... 5

**Repair..... 6**

Troubleshooting ..... 6

Replacing the power supply unit..... 8

Restoring the plug connection..... 9

Replacing the cistern lid..... 9

Positioning the servo lever ..... 10

Re-referencing the position of the servo lever ..... 10

Replacing the flush valve..... 11

Replacing the flat gasket for flush valve..... 12

Replacing the operating part for fill valve..... 12

# Safety

---

## Target group

Maintenance and repair work on this product may only be performed by skilled persons.

## Safety notes

- Only use original spare parts when making repairs
- Do not modify the product or add any additional modules

# Product description

## Structure

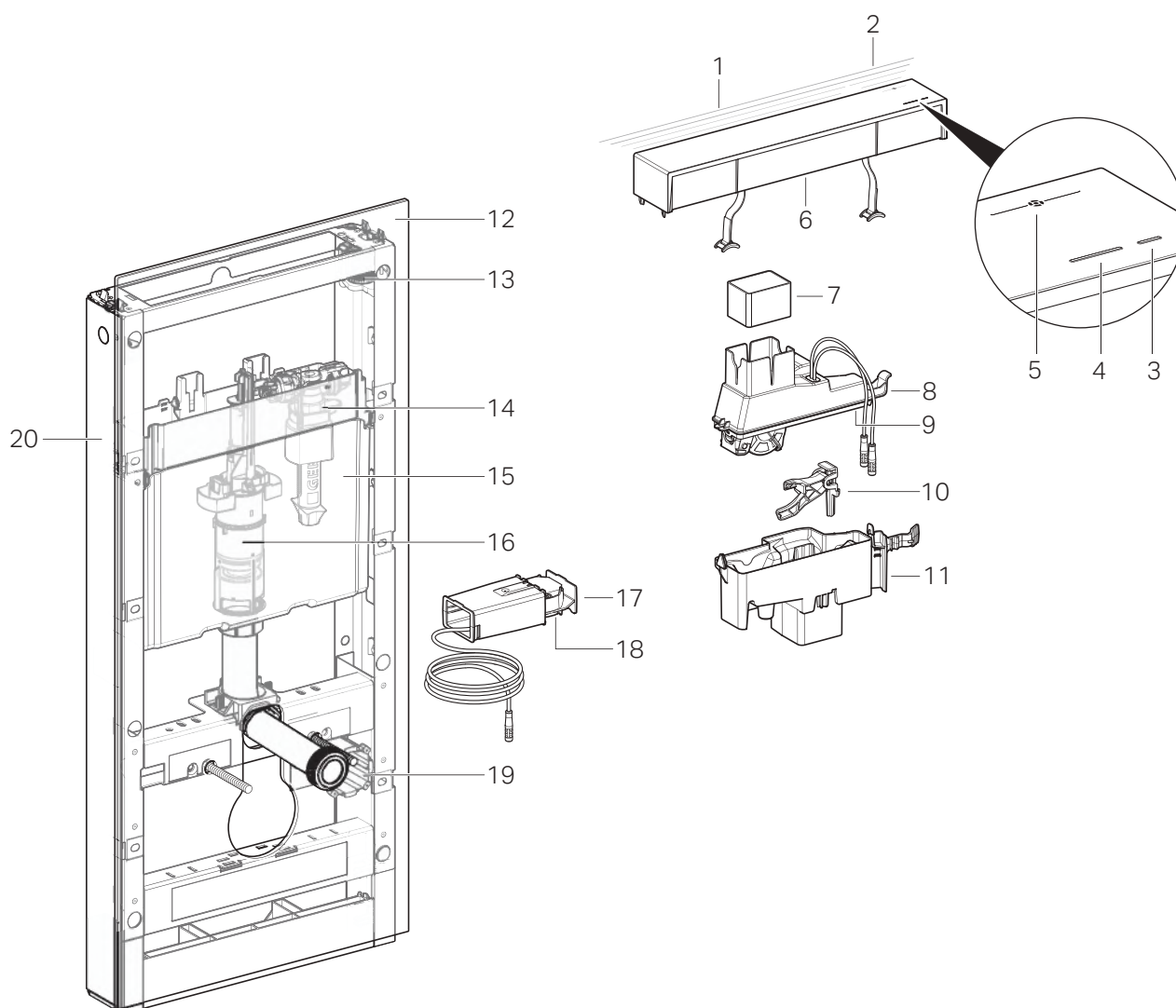

- 1 Orientation light
- 2 Odour extraction unit indicator light
- 3 <Small flush volume> button
- 4 <Large flush volume> button
- 5 <Odour extraction> button
- 6 Cistern lid
- 7 Ceramic honeycomb filter
- 8 Upper part of odour extraction unit
- 9 Servo lever
- 10 Actuator lever
- 11 Lower part of odour extraction unit
- 12 Front cladding made of glass
- 13 Angle stop valve
- 14 Fill valve
- 15 Cistern
- 16 Flush valve
- 17 Power supply unit
- 18 Power supply unit LED
- 19 Outlet mounting box
- 20 Side part

## Function

The sanitary module is equipped with user detection, an odour extraction unit and an orientation light. Soft-touch buttons are integrated in the cistern lid and can be used to release a large or small flush or activate the odour extraction unit.

The integrated odour extraction unit neutralises unpleasant odours from the WC ceramic appliance.

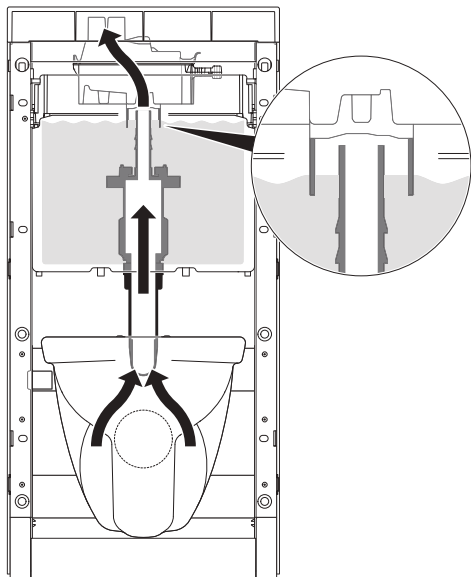

## Troubleshooting

Fault	Cause	Rectification
No function and LED on power supply unit does not light up	Fuse on electrical distributor of home has tripped	▶ Restore the power supply
	Power supply unit is defective	▶ Replace the power supply unit
No function and LED on power supply unit is lit	Plug connection between power supply unit and cistern lid is not inserted	▶ Restore plug connection
	Control unit is defective	▶ Replace cistern lid
No flush after flushing process is actuated	Actuator lever missing or not hooked in	▶ Hook in actuator lever
	Servo lever is positioned incorrectly	▶ Position servo lever
	No water in the cistern	▶ Open water supply valve and check function of fill valve
	Float valve in fill valve is clogged	▶ Replace seals or fill valve
	Control unit is defective	▶ Replace cistern lid
Odour extraction unit not functioning	Odour extraction unit is set to <Switch on with button>	▶ Change settings (see user manual)
	Fan is defective (odour extraction unit indicator light and flush actuation functioning)	▶ Replace upper part of odour extraction unit
	Control unit is defective	▶ Replace cistern lid
Odour extraction is too long or too short	Extraction duration of odour extraction unit does not correspond to customer requirement	▶ Change settings (see user manual)
Odour extraction is weak or inefficient	Ceramic honeycomb filter is not inserted	▶ Insert ceramic honeycomb filter (see user manual)
	Ceramic honeycomb filter is worn out	▶ Replace ceramic honeycomb filter (see user manual)
	Not enough water in the cistern	▶ Set water level via the fill valve
Odour extraction unit is making disruptive whistling noise	Stall ring in flush valve is defective	▶ Replace flush valve
	Geometry of WC ceramic appliance is unsuitable	▶ Contact customer service
Orientation light does not light up	Orientation light setting is at <Off>	▶ Change settings (see user manual)
	Control unit is defective	▶ Replace cistern lid
Odour extraction unit indicator light does not light up	Control unit is defective	▶ Replace cistern lid
Cistern is not filling up	Angle stop valve is closed	▶ Open the angle stop valve
	Water collecting tray and float at fill valve are jammed	▶ Move water collecting tray and float up and down
	Membrane is dirty	▶ Remove and clean fill valve ▶ Replace the fill valve set of seals ▶ Replace the fill valve

<b>Fault</b>	<b>Cause</b>	<b>Rectification</b>
Flush volume is too low	Water level in cistern is too low	▶ Set water level via the fill valve
	Servo lever is not in the basic position	▶ Re-reference the position of the servo lever
Water running for a long time	Geometry of WC ceramic appliance is unsuitable	▶ Repair not possible
Water is running continuously into the WC ceramic appliance	Water level in cistern is too high; the water is flowing into the WC via the overflow pipe	▶ Set water level via the fill valve
	Seal at flush valve is leaky	▶ Replace the flat gasket for flush valve
	Seal at basket is leaky	▶ Replace section seal for basket or basket
	Seal seat of basket is damaged or dirty	▶ Replace basket
	Fill valve is leaky	▶ Replace seals or fill valve
	Water collecting tray and float at fill valve are jammed	▶ Free up water collecting tray and float
	Regulation spindle at fill valve has unhinged	▶ Hook in regulation spindle

## Replacing the power supply unit

### Prerequisites

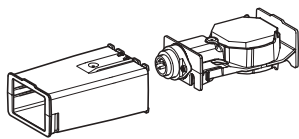

- 1 Hold the cistern lid with both hands, lift it up and fold it toward the front.

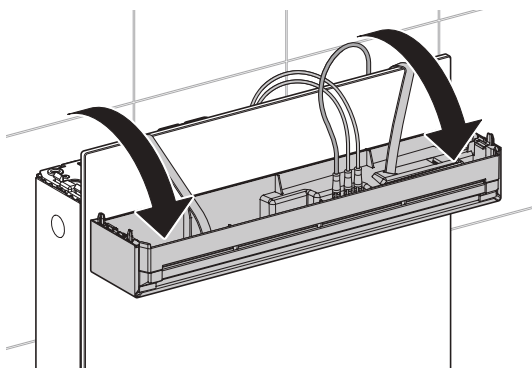

- 2 Remove the side parts.

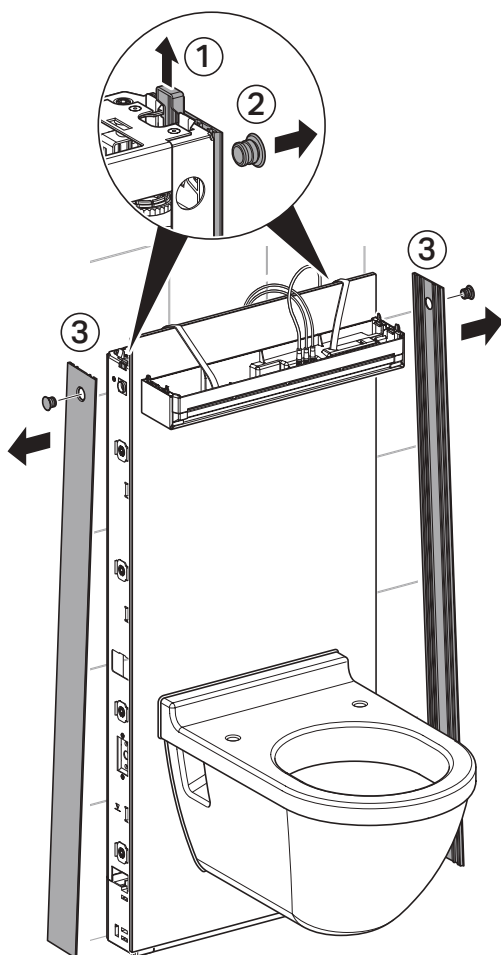

**i** The power supply unit will either be on the right- or left-hand side of the frame, depending on the installation situation.

- 3 Pull out the power supply unit retainer.

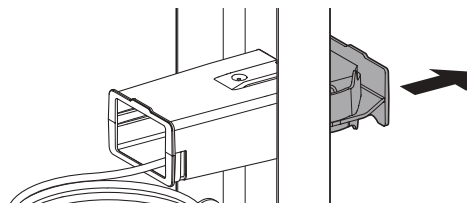

- 4 Remove the power supply unit.

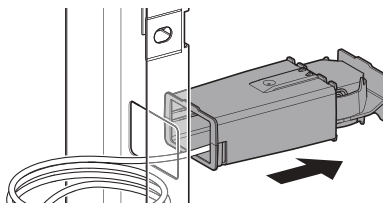

- 5 Remove the mains cable from the power supply unit.

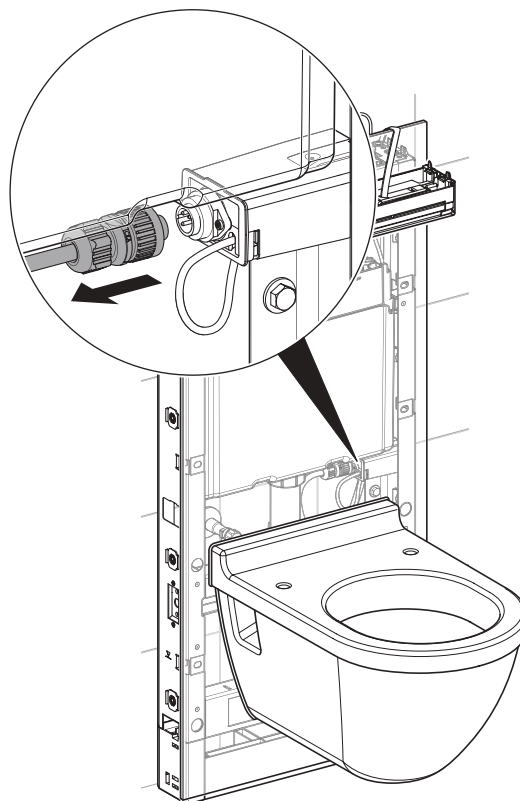

- 6 Replace the power supply unit.



## Restoring the plug connection

- 1** Hold the cistern lid with both hands, lift it up and fold it toward the front.

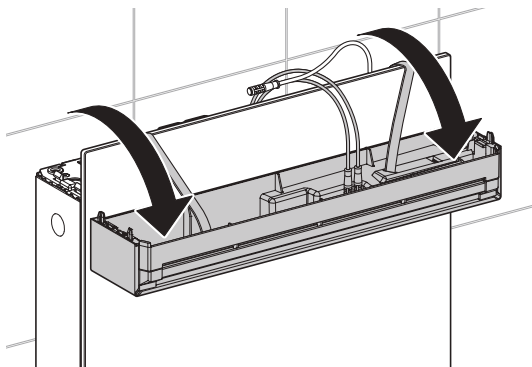

- 2** Restore the plug connection.

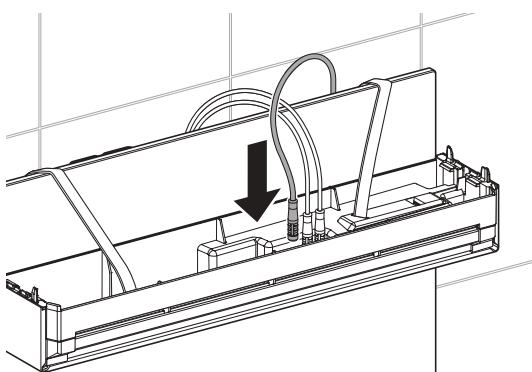

## Replacing the cistern lid

### Prerequisites

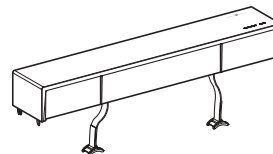

- 1** Hold the cistern lid with both hands, lift it up and fold it toward the front.

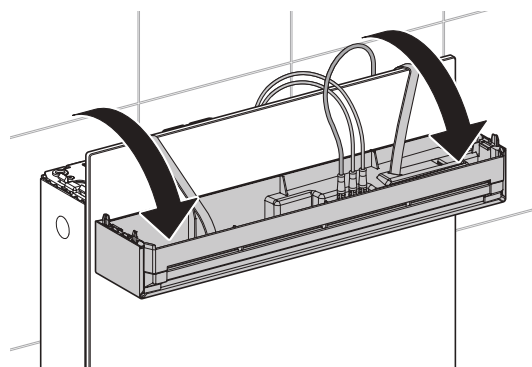

- 2** Disconnect the plug connections.

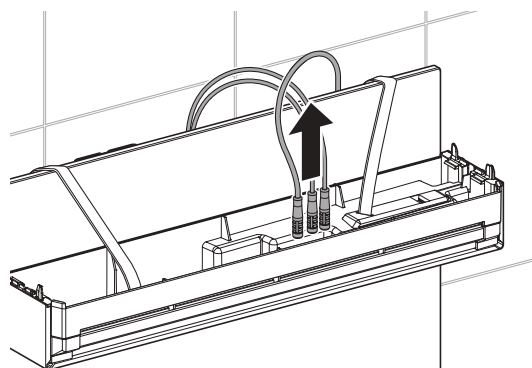

- 3** Loosen the lid retainers at the frame and replace the cistern lid.

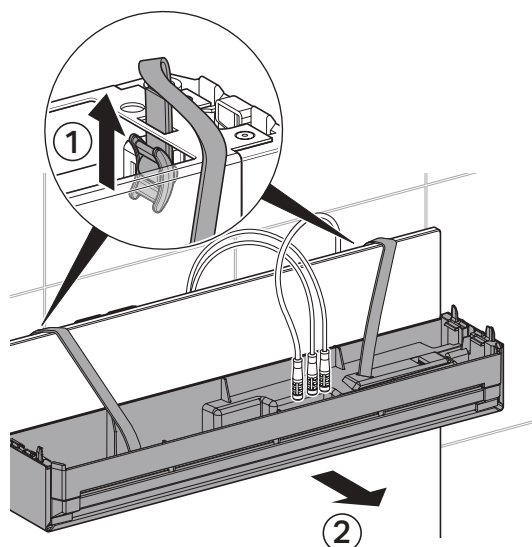

## Positioning the servo lever

- 1** Remove the upper part of the odour extraction unit.
- 2** Move the servo lever to the basic position.

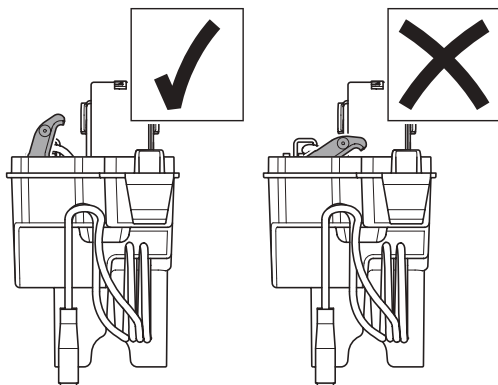
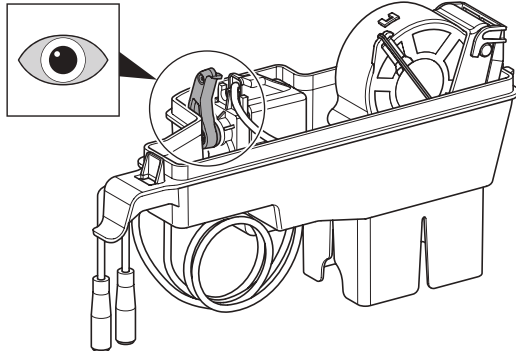

## Re-referencing the position of the servo lever

- 1** Hold the cistern lid with both hands, lift it up and fold it toward the front.

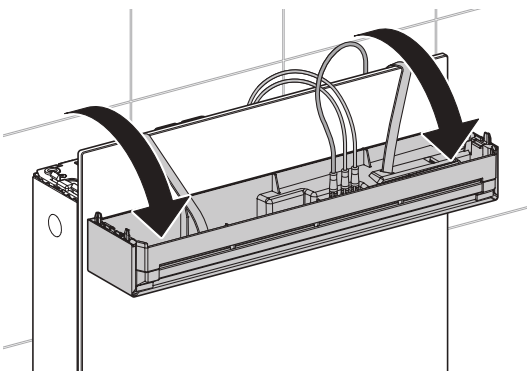

- 2** Disconnect the plug connections.

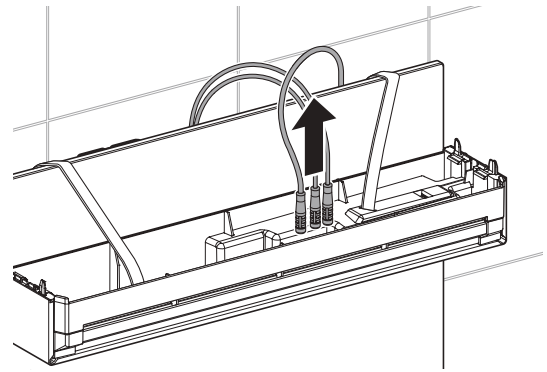

- 3** Wait at least 3 minutes.



- 4** Re-establish the plug connections.
- 5** Close the cistern lid.
- 6** Press the <Large flush volume> button.

### Result

A large flush is actuated and the position of the servo lever is re-referenced in the process.

## Replacing the flush valve

### Prerequisites

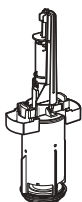

- 1** Hold the cistern lid with both hands, lift it up and fold it toward the front.

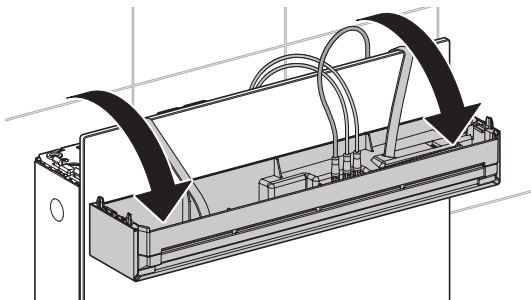

- 2** Disconnect the plug connections.

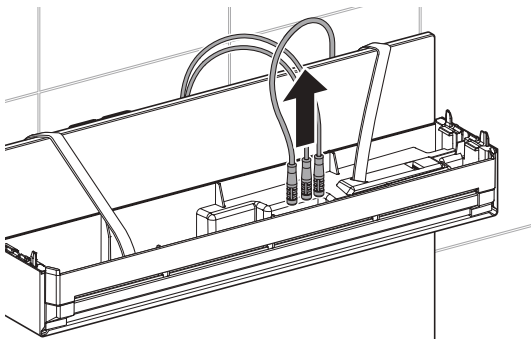

- 3** Remove the upper part of the odour extraction unit.

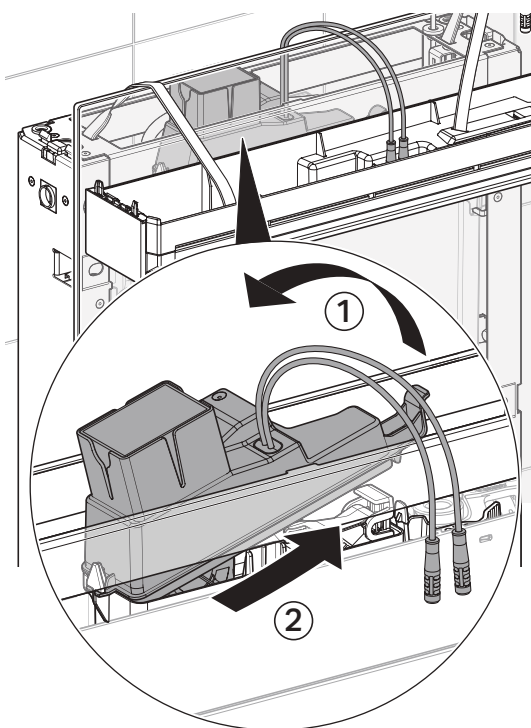

- 4** Remove the actuator lever.

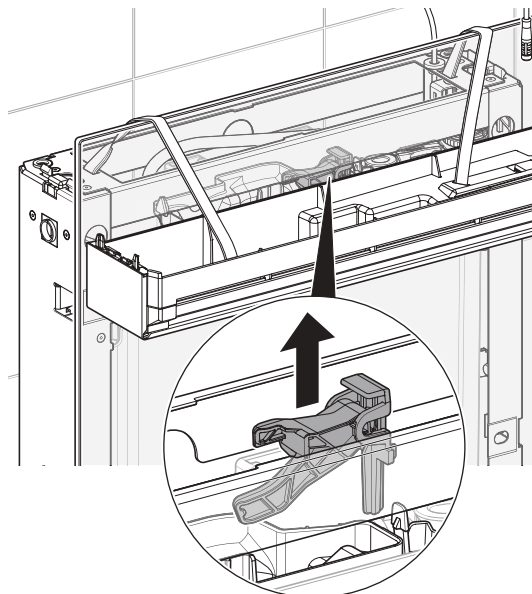

- 5** Loosen and remove the lower part of the odour extraction unit together with the fill valve.

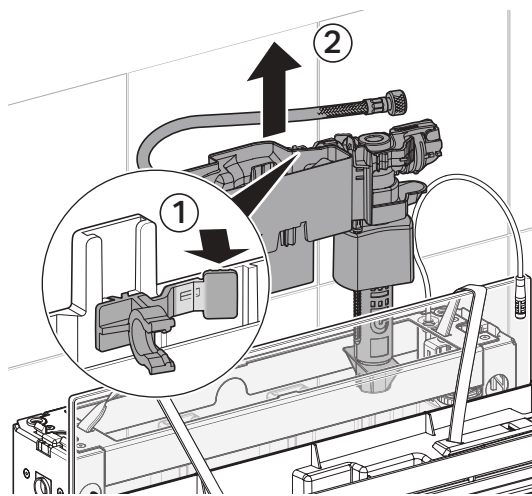

- 6** Remove the flush valve.

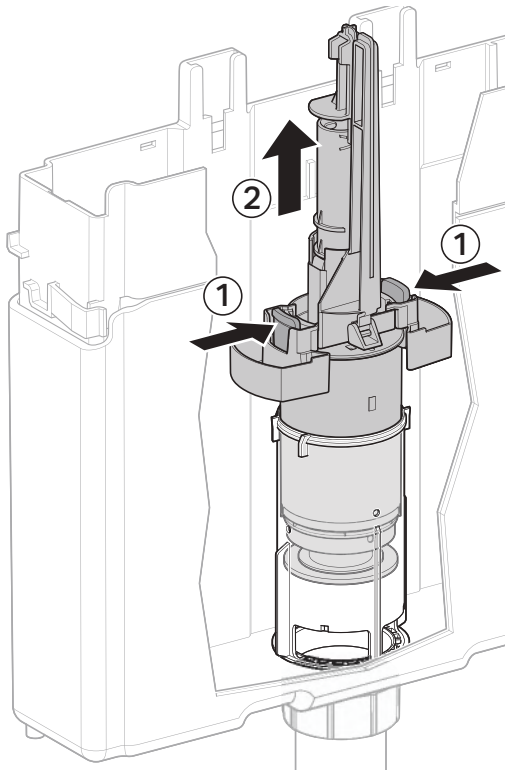

**7** Remove the basket.

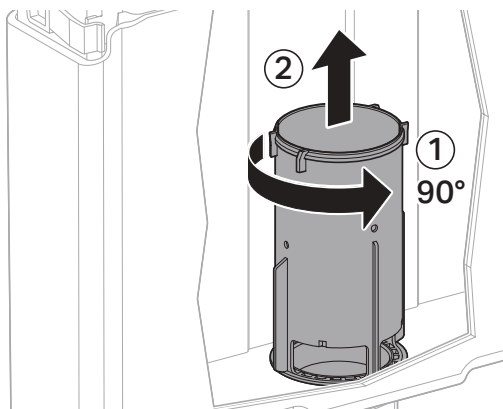

**8** Lubricate the section seal for basket.

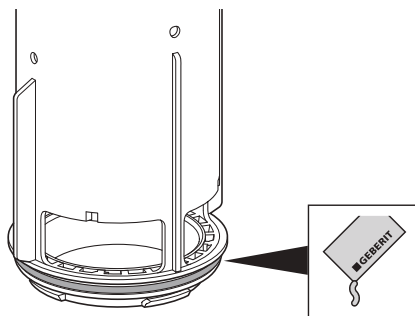

**9** Replace the flush valve.

## Replacing the flat gasket for flush valve

Prerequisites



Flush valve removed.

**1** Remove and replace the old flat gasket for flush valve.

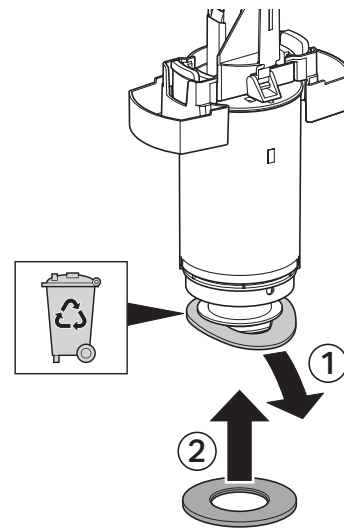

## Replacing the operating part for fill valve

Prerequisites

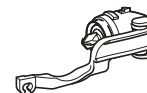

Fill valve removed.

► For installation, see the installation manual included with the spare part.

Geberit International AG, Schachenstrasse 77, CH-8645 Jona  
T +41 55 221 63 00  
F +41 55 221 63 16  
documentation@geberit.com  
→ www.geberit.com